

Stainless Steel Shear Beam Load Cell

MP 58, MP 58T



91 kg... 2,268 kg Type
C3MR (200 lb... 5,000 lb)

- Full stainless steel construction
- Compatible with other sources
- Approved according to OIML R60
- Ex-Version available (MP58/...E, MP58T/...E)
- Matched output
- High input impedance

Applications

- Platform scales
- Tank & Hopper scales

Technical Data		C3MR	
Accuracy class		0.02	% E_{max}
Maximum capacity	E_{max}	s. table	
Max. usable load	E_u	200	% E_{max}
Destructive load	E_d	> 300	% E_{max}
Minimum LC verification interval $v_{min} = E_{max}/Y$	Y	11,500	
Rated output	C_n	2.0	mV/V
Tolerance on rated output	d_c	≤ 0.1	% C_n
Zero output signal	S_{min}	≤ 5.0	% C_n
Creep, during 30 min.	d_{cr}	≤ 0.016	% C_n
Temperature effect on S_{min}	TK_{Smin}	≤ 0.011	% $C_n/10K$
Temperature effect on C	TK_C	≤ 0.010	% $C_n/10K$
Input impedance	R_{LC}	1,100 ± 50	Ω
Output impedance	R_o	1,000 ± 2	Ω
Insulation impedance	R_{IS}	> 5,000	MΩ
Recommended supply voltage	B_u	5... 15	V
Maximum supply voltage	U_{max}	15	V
Nominal ambient temperature range	B_T	-10 ... +40	°C
Usable ambient temperature range	B_{Tu}	-30 ... +70	°C

Technical Data

C3MR

Nominal deflection	$E_{\max} = 91 \text{ kg}, 227 \text{ kg}, 454 \text{ kg}$	$\leq 0,25$	mm
	$E_{\max} = 1,134 \text{ kg}$	$\leq 0,3$	mm
	$E_{\max} = 2,268 \text{ kg}$	$\leq 0,56$	mm
Cable length		3	m
Environmental protection		IP 67	

The technical data given here serve only as a product description and must not be interpreted as guaranteed characteristics in the legal sense.

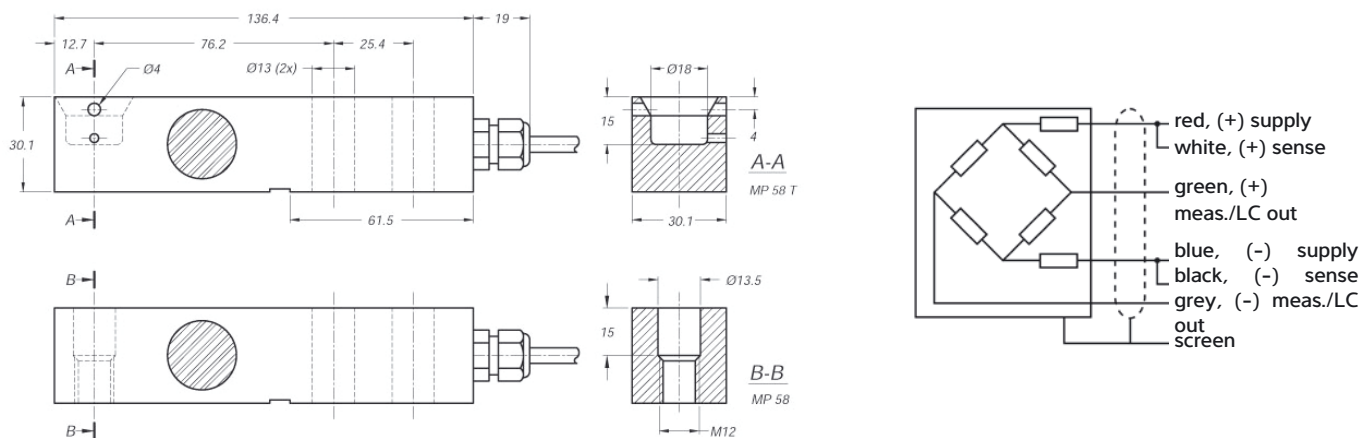

Order information

Type	Order number	Type	Order number
MP 58/91kgC3MR	9408 258 07090	MP 58/91kgC3MRE	9408 658 07090
MP 58/227kgC3MR	9408 258 07120	MP 58/227kgC3MRE	9408 658 07120
MP 58/454kgC3MR	9408 258 07150	MP 58/454kgC3MRE	9408 658 07150
MP 58/1134kgC3MR	9408 258 07210	MP 58/1134kgC3MRE	9408 658 07210
MP 58/2268kgC3MR	9408 258 07220	MP 58/2268kgC3MRE	9408 658 07220
MP 58T/91kgC3MR	9408 258 17090	MP 58T/91kgC3MRE	9408 658 17090
MP 58T/227kgC3MR	9408 258 17120	MP 58T/227kgC3MRE	9408 658 17120
MP 58T/454kgC3MR	9408 258 17150	MP 58T/454kgC3MRE	9408 658 17150
MP 58T/1134kgC3MR	9408 258 17210	MP 58T/1134kgC3MRE	9408 658 17210
MP 58T/2268kgC3MR	9408 258 17220	MP 58T/2268kgC3MRE	9408 658 17220

Certificate of conformity

MP 58 (optional)

Ex-Zone 2, 22
 II 3G Ex nA II T6
 II 3D Ex tD A22 IP65 T85°C

MP 58/.E

Ex-Zone 0, 1, 20, 21
 II 1G Ex ia IIC T6|T5 Ga
 II 1D Ex ia IIIC IP67 T100°C
 Da



Accessories

MP 80 | MP 90 – Cables and cable junction

boxes MP 80 Installation cable

- Temperature range: -40°C ... +90°C
- Material: TPE
- 6-wire cable

MP 90/04 Cable junction box

- Temperature range: -20°C ... +70°C
- Material: ABS
- Protection class: IP65

MP 80/31	Meteor installation cable 30 m	9408 800 80311
MP 80/51	Meteor installation cable 50 m	9408 800 80511
MP 80/12	Meteor installation cable 100 m	9408 800 80121
MP 80/32	Meteor installation cable 300 m	9408 800 80321
MP 80/80	Grounding cable	9408 800 80801
MP 90/04	Cable junction box for up to 4 load cells	9408 800 90041

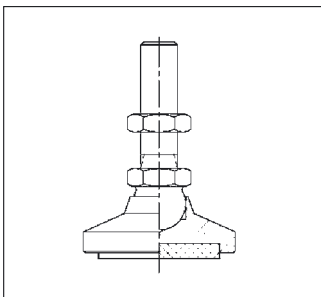

Platform foot for MP 58 and MP 79

- Mounting solution for weighing platforms
- Height adjustable
 - 6 mm
- Temperature range: -20°C ... +65°C
- S-versions suitable for food industry
- Material:
 - stainless steel 1.4301

PR 91/00 S	Platform foot for MP 58 and MP 79 up to 2,268 kg (M12)	9405 300 91002
PR 91/01 S	Platform foot for MP 58 and MP 79 up to 2,268 kg, stainless steel (M12)	9405 300 91012

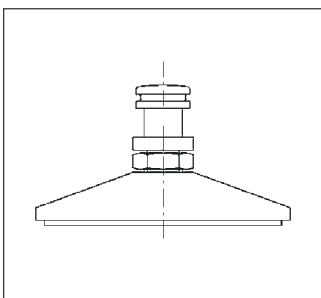

Platform foot for MP 58T and MP 79T

- Mounting solution for weighing platforms
- Height adjustable 6 mm
- Temperature range: -20°C ... +65°C
- S-versions suitable for food industry
- Material: stainless steel 1.4301

PR 91T/00 S	Platform foot for MP 58T and MP 79T up to 2,268 kg, stainless steel	9405 300 91004
-------------	---------------------------------------------------------------------	----------------

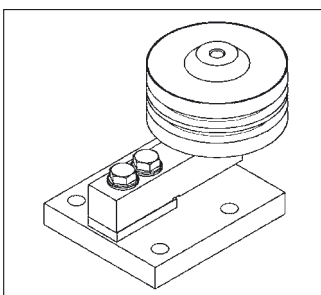

MP 92 - Rubber Mounting Kit

- Simple mounting solution for tanks and hoppers
- Temperature range: -20°C ... +65°C
- Material: mild steel, chromated
- Permissible horizontal displacement: 2.5 mm

PR 92/00 N	Mounting Kit with rubber element for MP 58 and MP 79 up to 2,268 kg (M12)	9505 300 92001
------------	---------------------------------------------------------------------------	----------------

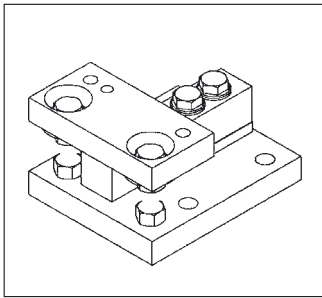

PR 95T - Mounting Kit (without constrainer)

- Simple mounting solution for tanks and hoppers
- Dummy function
 - PR 95T/00 S: 1t
- lift-off protection
 - PR 95T/00 S: 30 KN
- Material: stainless steel 1.4301

PR 95T/00 S

Mounting kit for MP 58T and MP 79T up to 2,268 kg, stainless steel

9405 300 95004

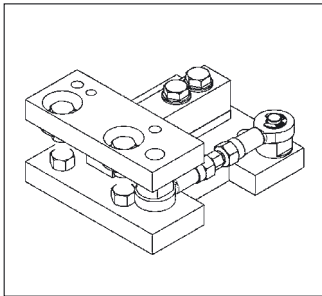

PR 95T - Mounting Kit (with constrainer)

- Simple mounting solution for tanks and hoppers with integrated constrainer with jack-up device (dummy function) and integrated lift-off protection
- Temperature range: -30 ... +80°C
- Dummy function
 - PR 95T/10 S: 1t
- lift-off protection
 - PR 95T/10 S: 30 KN
- Integrated Constrainer
 - PR 95T/10 S: 5 KN
- Material
 - stainless steel 1.4301

PR95T/10 S

Mounting kit with constrainer for MP 58T and MP79T up to 2,268 kg

9405 300 95104

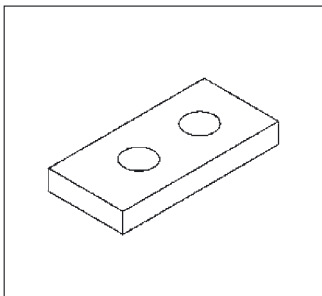

PR 98 - Spacer

- Spacer for MP 58(T) and MP 79(T)
- Material: 1.4021

PR 98/00 S

Spacer for MP 58(T) and MP 79(T) up to 2,268 kg

9405 300 98002